

LUCIUS

COMPACT TOPLIGHT

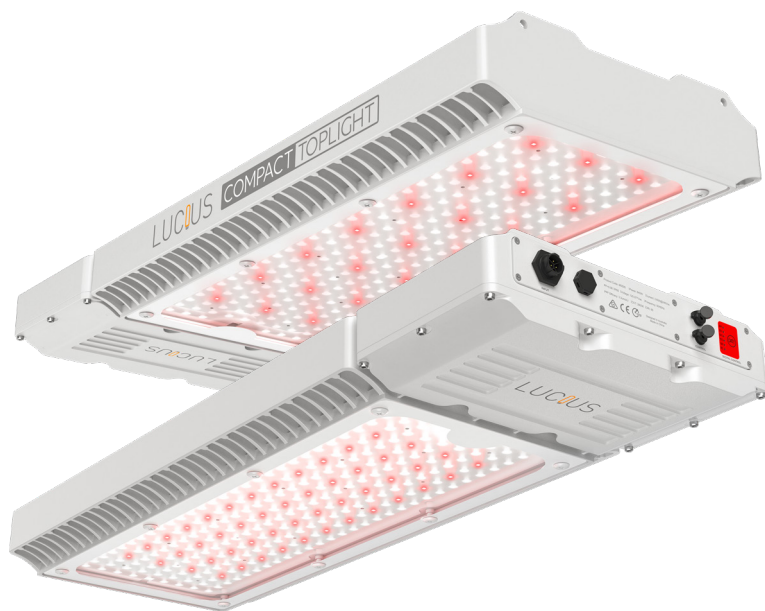

USER MANUAL



INTRODUCTION

Congratulations on purchasing your LUCIUS COMPACT TOPLIGHT. Please read and understand this manual in its entirety before using the LUCIUS COMPACT TOPLIGHT.

Have a certified personnel to install this fixture. Only use this product as specified within the manual.

1. PRODUCT DESCRIPTION

Introducing the LUCIUS COMPACT TOPLIGHT SERIES, designed for horticultural commercial spaces and greenhouses.

Featuring manual dimming and controller compatibility, these lights are versatile and easy to control.

Equipped with greenhouse-compatible hangers, these lights seamlessly replace HID fixtures, maximizing productivity and efficiency.

2. CONTENTS

- A

COMPACT TOPLIGHT
- B

Input Power Cable 2.4m
- C

LED Hanger (x2)
- D

Strut Hanger (x2)

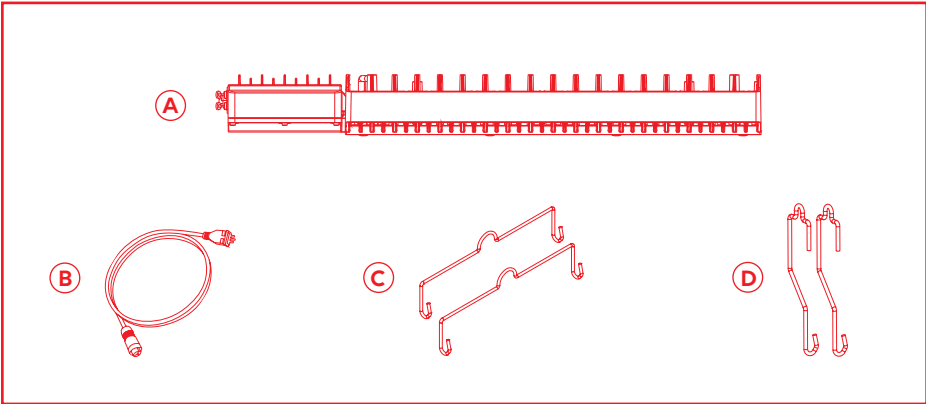

3. TECHNICAL SPECIFICATIONS

Test data has a tolerance of ±3%.

Product Code	M5500	M5505
Power	840W	
Voltage Range/ Frequency	120-277Vac ~ 50/60Hz	
Current	120V	7.06A
	208V	4.12A
	220V	3.91A
	230V	3.75A
	240V	3.60A
	277V	3.15A
Max PPF	2352µmol/s	2772µmol/s
Nominal PPF Efficacy	2.8µmol/J	3.3µmol/J
Max PPF Efficacy	3.0µmol/J@50%	3.5µmol/J@50%
CCT	5000K	2800K
CRI	85%	65%
PF	>0.96	
THD	<10%	
Beam Angle	120°	
Control	OFF / 25% / 50% / 75% / 100% / RC	
External Control	Compatible with 0-10V LED Controllers	
Signal Wire	3.5mm TRS Male Jumper Cable	
Thermal Management	Passive	
BTU/h	2867	
Protection	Over-Voltage , Over-Current, Short Circuit, Over-Temperature	
Dimensions	814 x 320 x 92mm 32.0 x 12.6 x 3.6"	
Weight	11.5±0.3kg 25.4±0.66Lbs	
Working Temperature	0°C to 40°C /32°F to +104°F (95% RH)	
Storage Temperature	-40°C to 70°C /-40°F to +158°F (85% RH)	
IP rating	IP65	
Warranty	3 Years	
Certificates		

4. COVERAGE AREA

M5500 - WHITE SERIES

Application	Vegetative	Flower	
¹ Hanging Height (cm)	121	84	76
Max PPFD ($\mu\text{mol/s/m}^2$)	500	1000	1200
Coverage Dimensions LxW (m)	1.73 x 1.66	1.76 x 1.68	1.74 x 1.64
² Coverage Area (m^2)	2.86	2.95	2.85

M5505 - R SERIES

Application	Vegetative	Flower	
¹ Hanging Height (cm)	132	92	84
Max PPFD ($\mu\text{mol/s/m}^2$)	500	1000	1200
Coverage Dimensions LxW (m)	1.92 x 1.83	1.93 x 1.84	1.91 x 1.82
² Coverage Area (m^2)	3.51	3.55	3.47

¹Hanging Height refers to the distance between the plant canopy and the LED.

²Coverage Area refers to the region that the plants receive at minimum 200PPFD for Flowering and 100PPFD for Vegetative.
See Lucius.com.au to view the PPFD Map

5. DIMENSIONS

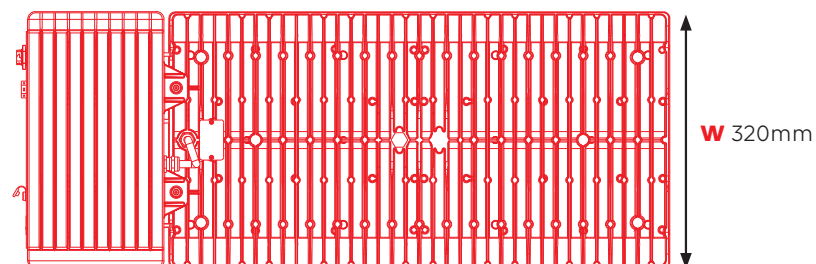
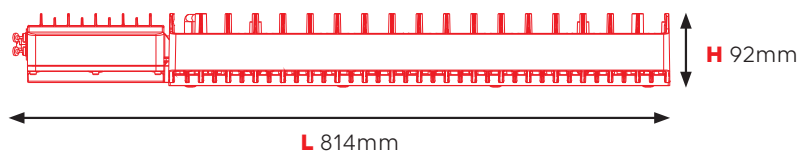

6. INSTALLATION

STEP. 1



Hook Strut Hangers to a secure surface.

STEP. 2

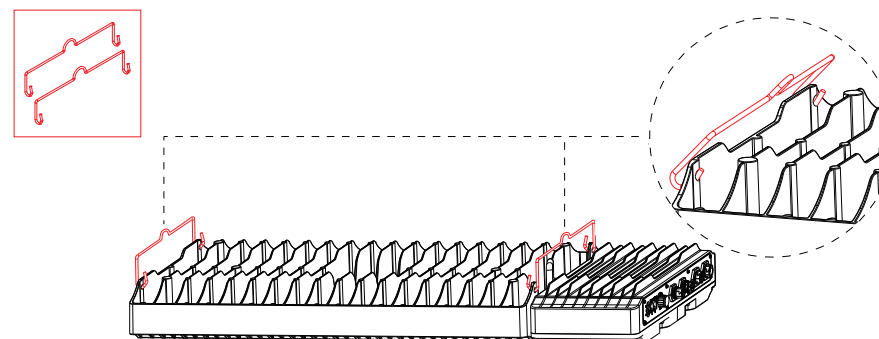

Angle and hook LED Hangers into the inserts on the Fixture.

STEP. 3

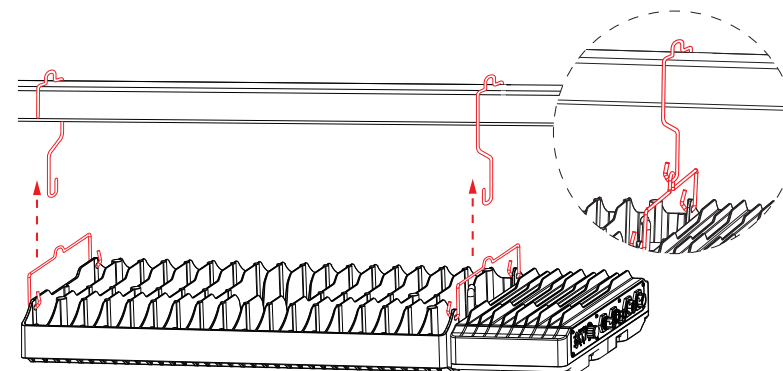

Using two people, lift and link the LED hangers to the Strut Hangers.

7. CONTROL

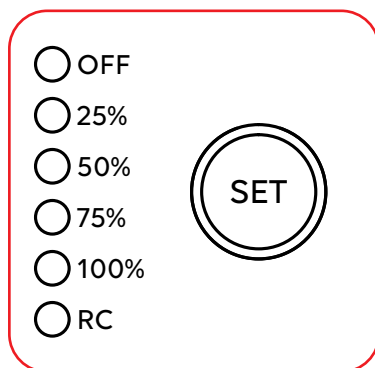

Powering On

Connect the Fixture to the power outlet using the AC Input Supply cable and power ON.

Digital Control

The Fixture features a 'Digital Control' that can switch between Power Dimming and Remote Control (RC) settings using the 'SET' button.

8. CONNECTING MULTIPLE LED FIXTURES

Connect the 3.5mm Male Jumper Cable between the Controller and the first 'IN' port on the Fixture.

To connect multiple Fixtures, continue to add Signal Cables between Fixture 'IN' & 'OUT' ports. Once connections are made, set the 'DIGITAL CONTROL' to 'RC' mode on all Fixtures.

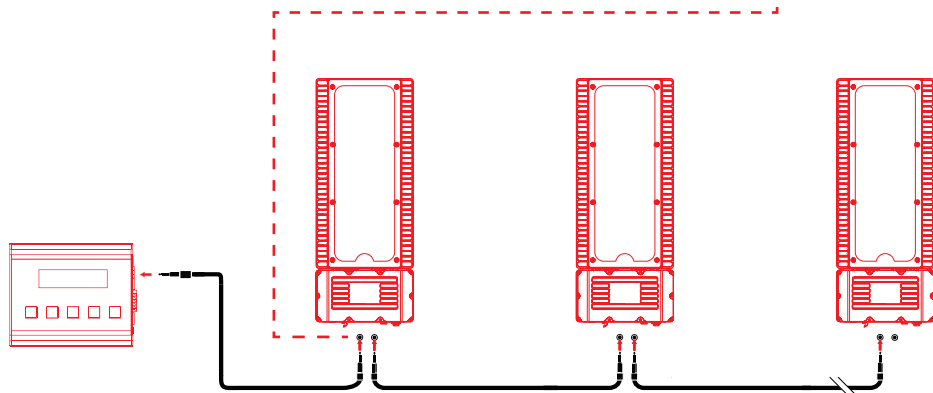
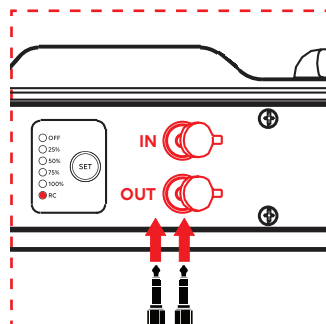

9. WARRANTY - CONTACT YOUR RETAILER FOR WARRANTY CLAIMS AND SUPPORT.

The company guarantees the mechanical and electronic components of this product. It ensures the materials and workmanship is free of defects, used under normal operating conditions.

If there are any defects with this product that relate to the workmanship or the materials used, the company shall, at its discretion, either replace or repair the product.

However, improper use is NOT covered by warranty. This includes but is not limited to, overloading, user error, physical or water damage.

Warranty is valid for a period of three years from the original date of purchase.

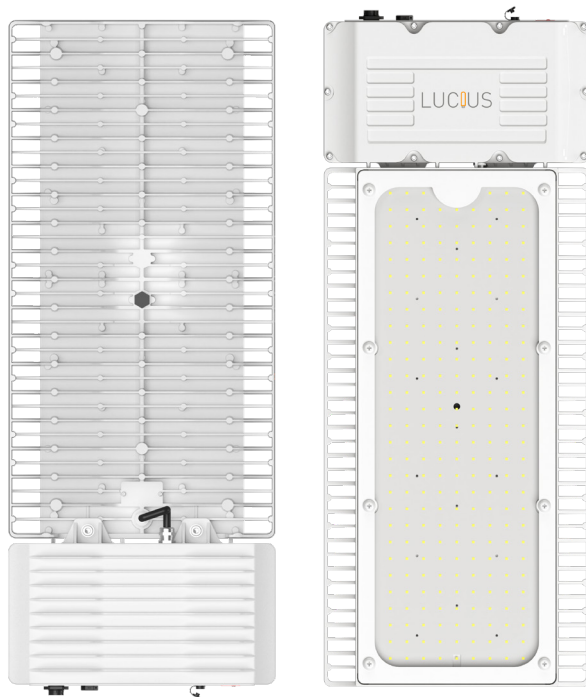

lucius.com.au